

Socket Cordless Ring Scanner 9P

with *Bluetooth*® Wireless Technology

Free Your Hands Using the Cordless Ring Scanner!

The Socket Cordless Ring Scanner (CRS) 9P with *Bluetooth* Wireless Technology is a unique wearable device that enables you to scan bar codes while keeping your hands free. The first product of its kind with a built-in wireless communicator, the CRS 9P combines the power of laser bar code scanning with the convenience of *Bluetooth* wireless technology to provide an efficient, hands-free solution that makes scanning as simple as pointing your finger!



The CRS 9P features "fuzzy logic" technology, which makes it possible to scan even damaged, poor quality or hard-to-read bar codes. For maximum performance, the robust and ruggedized CRS 9P features a powerful Class 2 laser with fuzzy logic so that you can successfully scan in the harshest conditions, even VIN bar codes through car windshields outdoors in broad daylight!

Socket's exclusive *Error Proof Protocol* (patent pending) ensures that scanned data is correctly received by your Pocket PC, notebook or tablet PC and allows for real-time validation of data and notification to the user in case of errors.

The wireless module worn on the wrist has a powerful *Bluetooth* radio that maintains a strong connection to your mobile computer without dangling cables or protruding antennas to slow you down, restrict your movement or cause potential hazards. The CRS 9P was designed with an exclusive Liquidmetal® construction that is twice as strong as titanium, extremely durable and scratch-resistant.

Mobility Friendly™ Design

The CRS uses minimal power, so you can operate for a full workday without having to recharge the battery. The included SocketScan™ software directs scanned data into any Windows application as if it were manually typed. Plus, Socket's renowned *Bluetooth* technology makes it easy to establish and maintain a reliable connection between the CRS and mobile computer.



Cordless

Cordless Ring Scanner Features

- Worn on index finger and can be triggered by either the thumb or middle finger
- Class 2 laser with fuzzy logic designed for demanding scanning requirements
- Exclusive Liquidmetal® rugged case design withstands multiple 5-foot drops
- Exclusive *Error Proof Protocol* (pat. pend.):
 - Prevents errors in wireless transmission of data to host computer
 - Allows for real-time data validation
 - Good scan signal appears only after data is received and confirmed by host

Wireless Bluetooth Module Features

- Class 1 *Bluetooth* radio has maximum range of 330 ft (100 m)
- Compatible devices if *Bluetooth* enabled:
 - Pocket PC running:
 - Windows Mobile 5.0, 2003/2003SE
 - Windows CE 3.0 or greater
 - Windows XP Tablet or Notebook PC
- Uses *Bluetooth* Serial Port profile
- Powered by a rechargeable lithium-ion battery
- Expected battery life (typical operating conditions): 10,000 scans in 8 hours
- Battery status warning light
- Connection indicator light

SocketScan Features

- SocketScan™ keyboard emulation software directs scanned data into any Windows program
- SocketScan allows the user to add Prefix and/or Suffix functions, such as Carriage Return and Tab, to further eliminate manual keystrokes
- Any of 19 bar code symbologies can be easily enabled or disabled with SocketScan's "Symbology Selector"
- SocketScan "Scan Demo" for Pocket PCs reports the symbology, length and decoded data of any scanned bar code

Socket Cordless Ring Scanner

with Bluetooth® Wireless Technology



Cordless Ring Scanner 9P
with Bluetooth Wireless Technology

CRS 9P Dev Kit: SKU# RS5500-688

Items not shown to scale and may vary slightly from those shown.

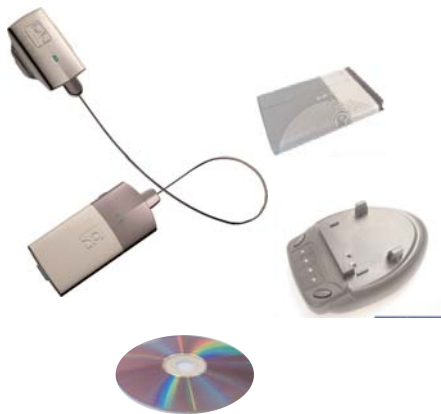

In the Box: (clockwise from top left)

- Cordless Ring Scanner 9P with Bluetooth Wireless Technology
- Rechargeable lithium-ion battery
- Wrist and ring strap
- Battery charger
- CD with software and user documentation



SPECIFICATIONS

Physical Characteristics

Wrist Unit Size: 98l x 13.1h x 47w (mm)
3.86l x 0.52h x 1.85w (in.)
Ring Size: 55l x 37h x 38w (mm)
2.17l x 1.46h x 1.5w (in.)
Total Mass: approx. 90 g (3.2 oz)

Power Source: Rechargeable lithium-ion battery BL-6C

Expected Battery Life - Typical Usage
with Bluetooth connection:
Minimum 10,000 scans in 8 hours

Exclusive Ruggedized Liquidmetal Case Design

- Withstands multiple 5-ft drops to concrete
- Scratch resistant

Operating Temp: -4 to +140°F
(-20 to +60°C)

Operating System Support

- Windows Mobile 5.0, 2003/2003SE
- Windows CE 3.0 or greater
- Windows XP, XP Tablet Edition

Interface Standards:

Bluetooth Serial Port Profile

Warranty: Two years

Scanning Characteristics

Bar Code Symbolologies Decoded:

UPC/EAN, Code 39, Code 128, RSS-14, Code 93, MSI, Codabar, I 2 of 5, D 2 of 5, and more

Laser Scanner Performance:

Scan Repetition Rate:

50 (± 3) scans/sec (bi-directional)

Decode Distances: 2.2 to 30+ inches depends on bar code size, symbology, label media, W-N Ratio, scan angle

For more information, please refer to the *User's Guide:* www.socketcom.com/support/support_cordless.asp

Laser with Fuzzy Logic: Class 2

SocketScan™ Software:

- Reads bar code data into any Windows application as if it were manually typed
- Lets you add Prefixes and/or Suffixes (e.g., Carriage Return or Tab) to further eliminate manual keystrokes
- Lets you assign a beep tone or .WAV file to signal a good scan
- Lets you easily enable/disable any of 19 supported symbologies
- Scan Demo (Pocket PC only) reports the symbology, length and decoded data (in ASCII or Hex) of any scanned bar code (among 19 supported symbologies)

Bluetooth Characteristics

Protocol: Bluetooth 2.45 GHz ISM band frequency hopping

Antenna: Integrated

Radio Range: Up to 330 ft (100 m), depending on environment

Connection: Point-to-point

Security: Encrypted link

RF Power: Class 1 radio; Typ. Output: 14 dbm

Certification/Compliance (pending)

FCC: Part 15, Class B

CE: EN55024:1998 C-TICK: s.182

Bluetooth 1.1

TELEC

ETS 300 328

ETS 300 826



ADDITIONAL PRODUCT INFORMATION

Sales Offices

Corporate Headquarters:

37400 Central Court
Newark, CA 94560

Phone: 510-744-2700

Domestic Toll Free: 800-552-3300

Fax: 510-744-2727

Online: www.socketcom.com/contact

Web: www.socketcom.com

Learn about Class 1 and Class 2 lasers:

www.socketcom.com/pdf/TechBriefClass1Class2.pdf

Learn about vertical scanning solutions:

www.socketcom.com/solutions

Information is subject to change.

